

PROGRAMMING THE TOUCHSCREEN

Outside Schlage Button

- The first button you will press in the programming process.
- Can also be pressed to exit programming immediately.

Green Check Mark

- Blinks when a number key is pressed and when a function is complete.



Red X

- If there is a problem during programming, you will see the red error X.

Programming Indicator

- Blinks when Programming Mode is entered
- Solid while a programming function is being performed.

Tips for Successful Programming

- ① Watch the video before you begin! Browse to answers.schlage.com and watch **User and Alarm Programming For Touchscreen Deadbolt**.
- ① Default Codes are located on the back of the Alarm Assembly, and on the back of this guide.
- ① The lock comes preset with a unique default Programming Code and two unique Default User Codes. Use these codes to operate your lock or change them using the instructions in this guide.
- ① If you would like to use a home automation system to enable remote control of the lock, refer to **Enrolling on a Z-Wave Network** on page 13.

Programming Descriptions

| | |
|--|---|
| Add User Code | User Codes unlock the deadbolt. Can be 4 - 8 digits long. All codes must be the same length. See Change User Code Length on page 7. |
| Delete User Code | Removes one User Code at a time. |
| Change Programming Code | The Programming Code is used to put the lock into Programming Mode. It is 6 digits long. |
| Enable Vacation Mode | Prevents all user codes from unlocking the deadbolt . Enable for extra security while you are away for an extended period of time. |
| Disable Vacation Mode | Returns lock to normal operation. |
| Enable/Disable Beeper | The beeper can be turned off if desired. Beeps will still sound during programming. |
| Delete ALL User Codes | Removes ALL User Codes from the lock. |
| Enable/Disable Lock & Leave | When enabled: Press the Outside Schlage Button to lock the deadbolt. (Default setting). When disabled: Press the Outside Schlage Button and then enter a user code to lock the deadbolt. |
| Change User Code Length | User Codes can be 4 - 8 digits in length. Default is 4 digits. Changing the User Code length will delete all existing User Codes! |
| Enable/Disable Auto-Lock | When enabled, the lock will automatically relock 30 seconds after unlocking. (Disabled by default.) |
| Temporarily Disable Auto-Lock | Auto-Lock must already be enabled. While the deadbolt is locked, press the Outside Schlage Button and then enter a 4-8 digit User Code to unlock the deadbolt. Within 5 seconds, manually lock and unlock the deadbolt using the thumbturn. |
| Restore Auto-Lock | Lock the deadbolt using the thumbturn. |

Programming Procedures

- ① Determine how long you want your User Codes to be BEFORE adding any User Codes. If you change the User Code length, all existing User Codes will be deleted!

① Programming Mode will automatically time out after 30 seconds of inactivity.

1. Open the door and extend the deadbolt before beginning.
2. If you make a mistake, press the Outside Schlage Button to leave Programming Mode, and then start over.

WRITE YOUR PROGRAMMING CODE HERE FOR EASY ACCESS



| FUNCTION | ENTER PROGRAMMING MODE (PRESS) | FUNCTION STEPS (PRESS) | VERIFY |
|--|---|--|--|
| Add User Code | SCHLAGE → 6 Digit Programming Code | 1 → New 4-8 Digit User Code → Same New 4-8 Digit User Code ↑ Add another code | ✓ 2 blinks + 2 beeps |
| Delete User Code | SCHLAGE → 6 Digit Programming Code | 2 → 4-8 Digit User Code → Same 4-8 Digit User Code ↑ Delete another code | ✓ 2 blinks + 2 beeps |
| Change Programming Code | SCHLAGE → 6 Digit Programming Code | 3 → New 6 Digit Programming Code → Same New 6 Digit Programming Code | ✓ 2 blinks + 2 beeps |
| Enable Vacation Mode | SCHLAGE → 6 Digit Programming Code | 4 → | ✓ 2 blinks + 2 beeps |
| Disable Vacation Mode | SCHLAGE → 6 Digit Programming Code | → | ✓ 2 blinks + 2 beeps |
| Enable/Disable Beeper | SCHLAGE → 6 Digit Programming Code | 5 → | ✓ Enable: 1 blink + 1 beep Disable: 2 blinks + 2 beeps |
| Delete ALL User Codes | SCHLAGE → 6 Digit Programming Code | 6 → 6 Digit Programming Code → | ✓ 2 blinks + 2 beeps |
| Warning ! | Removes ALL User Codes from the lock. User Codes cannot be retrieved after they are deleted! | | |
| Enable/Disable Lock & Leave | SCHLAGE → 6 Digit Programming Code | 7 → | ✓ Enable: 1 blink + 1 beep Disable: 2 blinks + 2 beeps |
| Change User Code Length | SCHLAGE → 6 Digit Programming Code | 8 → Desired User Code Length → Same Desired User Code Length | ✓ 2 blinks + 2 beeps |
| Warning ! | Changing the User Code length will delete all existing User Codes! User Codes cannot be retrieved after they are deleted! | | |
| Enable/Disable Auto-Lock | SCHLAGE → 6 Digit Programming Code | 9 → | ✓ Enable: 1 blink + 1 beep Disable: 2 blinks + 2 beeps |
| Temporarily Disable Auto-Lock (deadbolt should be locked to begin) | SCHLAGE → 4-8 Digit User Code | → Within 5 seconds, manually lock and unlock the deadbolt using the thumbturn. | ✓ 1 blink + 1 beep |
| Restore Auto-Lock | Relock the deadbolt using the thumbturn. | | ✓ 2 blinks + 2 beeps |

PROGRAMMING THE ALARM

1 Powering the Alarm

The alarm is turned off by default. After installation, you'll need to turn on your alarm.

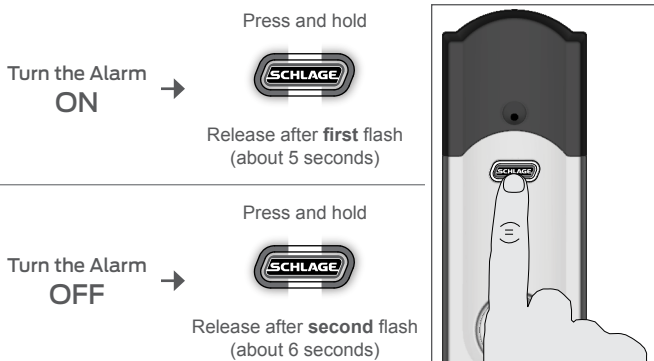

- ① Program the alarm using the Inside Schlage Button, shown below.
- ① Not sure your alarm is turned on? Simply press and release the Inside Schlage Button once. It will beep and light up to confirm it is activated. If it does not, try turning the alarm on again, and check the batteries.
- ① Watch the video before you begin! Browse to answers.schlage.com and watch **User and Alarm Programming For Touchscreen Deadbolt**.



- ① If you want to silence an alarm early, press and hold the Inside Schlage Button until the alarm sound stops.
- ① Want to hear what the alarm sounds like in Activity or Forced Entry mode? Enter an incorrect code four times and the alarm will sound.

2 Alarm Setting Descriptions

Decide which alarm setting is best for you.

| MODE | DESCRIPTION | LIGHTS | SOUNDS |
|---|--|--|---|
| Activity Alarms when the door opens or closes. | Perfect for monitoring doors while you're at home. <ul style="list-style-type: none"> • After the alarm is triggered, there is a built-in 3-second delay for it to reset. | Middle LED light flashes  | Two short beeps |
| Tamper Alarms when the lock is disturbed, while locked. | Senses subtle activity at the lock. | Left and right LED lights flash alternately  | 15 second Alarm (90 dB=similar to the volume of your smoke alarm) |
| Forced Entry Alarms when significant force pushes against the door, while locked. | Perfect for nighttime or when you're away from home. <ul style="list-style-type: none"> • Least sensitive mode – many choose to use this alert setting all the time. | All lights flash  | Three-minute shrill, steady alarm (90 dB=similar to the volume of your smoke alarm) |

3 Changing the Alarm Mode

After you power on the alarm, it will be preset to the Forced Entry mode, by default. If you want to change the mode, follow these simple steps:

① The alarm must first be powered on before changing the alert setting!

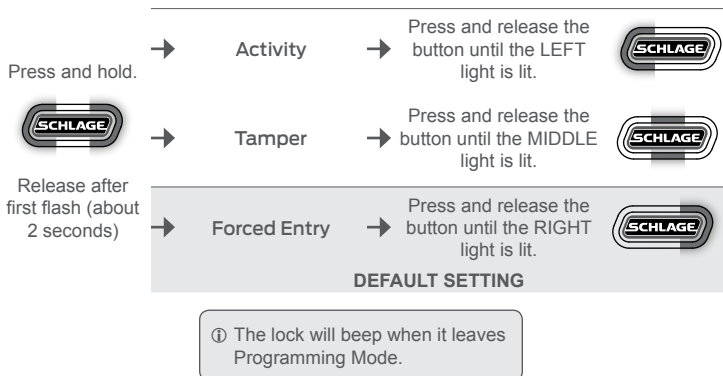

4 Adjusting the Sensitivity Level

Each alarm mode is preset to a sensitivity level of three. If your alarm is sounding too frequently, or not frequently enough, try changing this setting.

① You do not need to adjust this setting unless the alarm is sounding too frequently or not frequently enough.

① If you change the alarm mode, the sensitivity will revert back to the default setting.



① Each time you press and release the button, the alarm will beep/flash the same number of times as the setting level.

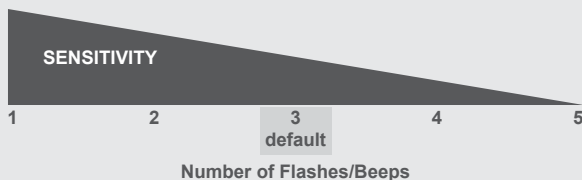

MY CODES

Use these tables to record Programming and User Codes that you program into the lock.

- The Programming Code can be any combination of six numbers entered into the keypad to put the lock in Programming Mode.
- The first 4 - 6 numbers (depending on User Code Length) must be different from all of the User Codes currently in the lock.
- One Programming Code is programmed into the lock by default. This code can be found on the stickers, one on the back of the Alarm Assembly and one on the back of this guide.

① Use a pencil to enter the codes in the boxes so you can easily change them later.

User Codes

- A User Code can be any combination of 4 - 8 digits entered into the keypad to unlock the lock.
- The first 4-6 digits must be different from the first 4-6 digits of the Programming Code.
- Two User Codes are programmed into the lock by default. These two codes can be found on the stickers, one on the back of the Inside Alarm Assembly and one on the back of this guide.

① Up to 30 User Codes can be stored in the lock at one time.

Best Practices

- Give each person their own unique User Code.
- Change User and Programming Codes periodically to ensure security.

Default Codes Locations

Codes are located on the sticker on the back of this guide. They are also located on the back of the Alarm Assembly.



The same codes are located in both places.

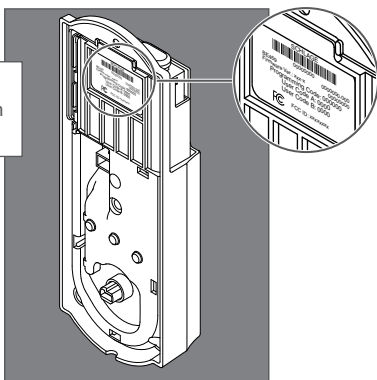

- ① DO NOT remove the sticker from the back of the Alarm Assembly! If you lose your Programming Code, you can reset your lock back to these default codes.